

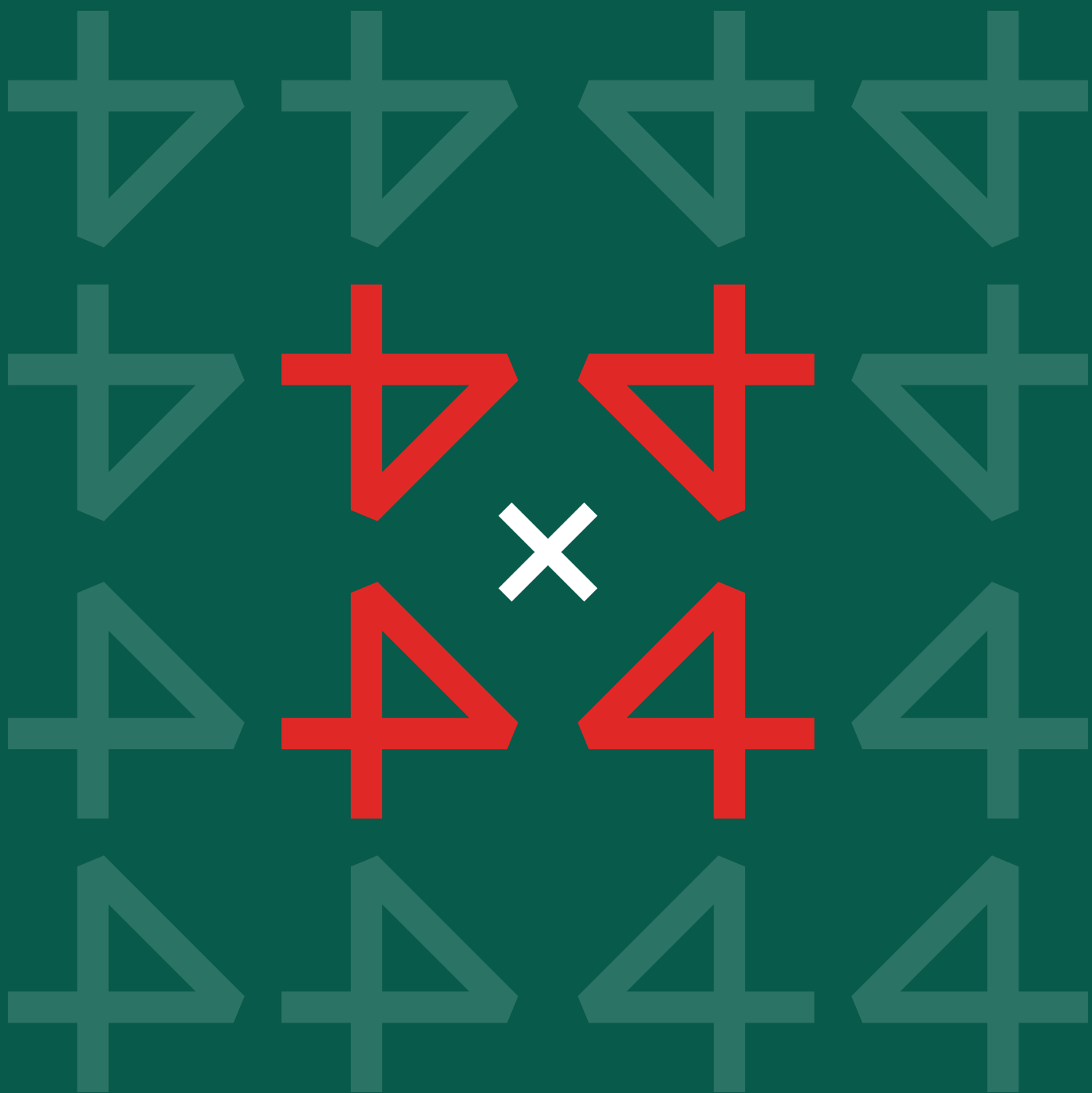

PRESENTED BY



ISSUE NO. 1 FEB. 2025



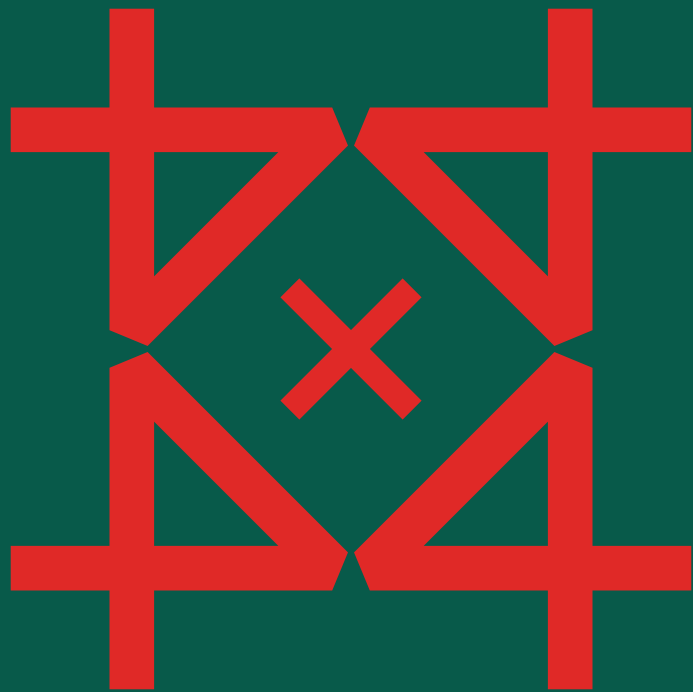



PRESENTED BY



Exclusive and enduring design series

Formica Group introduces **4x4**, a limited series of designer furniture that celebrates creativity, innovation and the essential role of materials. This collection of furniture pieces highlights the exceptional quality and versatility of the surfaces, demonstrating how they elevate design concepts into functional works of art.

4 series

4 top designers

16 exclusive pieces



Each furniture piece reflects the unique design philosophy of its creator, highlighting their personality, identity and style, while showcasing the versatility and enduring beauty of premium materials for interior design:

Formica® Laminate - the first and original, with stunning designs and unique textures.

Arpa® high quality surfaces made in Italy.

Homapal® real metal laminates with endless possibilities for creativity and personalisation.

FENIX® innovative materials with distinctive technological features and timeless elegance.





PRESENTED BY



4 designers, 4 different visions

Four visionary designers bring their expertise to this remarkable series - **Manuel Manuel Espejo, Nacho Álvarez, Sigfrido Serra and Virginia Albuja** - each creating four unique designs. Together they offer a fresh and innovative take on contemporary furniture, fusing individual creativity with the timeless appeal of the materials distributed by **Formica Group**.

This collaboration is a testament to the power of design to inspire, challenge and elevate everyday spaces. A manifestation where craftsmanship meets creativity in a limited series as unique as it is beautiful.

moblitte
design your world

All pieces in the 4x4 series are crafted using materials distributed by **Formica Group**, and exclusively produced by **Moblitte®** - a designer furniture brand born from this project, defined by its commitment to quality and its ability to embrace challenges as a core identity.



Opposite page, from left to right: *Nacho Álvarez, Manuel Espejo, Virginia Albuja and Sigfrido Serra.*





PRESENTED BY



Sarsen

by MANUEL ESPEJO

Manuel Espejo, a passionate creator of worlds, combines emotion, design and functionality to transform spaces into unique experiences.

Since childhood, he demonstrated a natural talent and a clear vocation, imagining and redrawing interiors. Trained in interior design and architecture at the prestigious IADE University, his professional career began in Spain's most renowned studios, where he stood out for his ability to convey emotions through his projects.

In 2007, Manuel founded his own studio in Madrid, surrounding himself with a team of experts who share his creative vision. Today, his firm is a benchmark in the world of interior design, characterised by a unique style that combines modernity, functionality and harmony.

His personalised approach adapts each space to the needs and personality of his clients, achieving environments that balance aesthetics and comfort in perfect harmony.







Sarsen
by MANUEL ESPEJO



PRESENTED BY







PRESENTED BY 

Sarsen

by MANUEL ESPEJO

— concept

The **Sarsen** sofa is a contemporary design piece that stands out for its straight, clean lines, evoking the majesty and solidity of the stones of *Stonehenge*. Its robust and minimalist structure is inspired by the shape and texture of these ancient formations, offering an air of elegance and stability to any space.

— dimensions

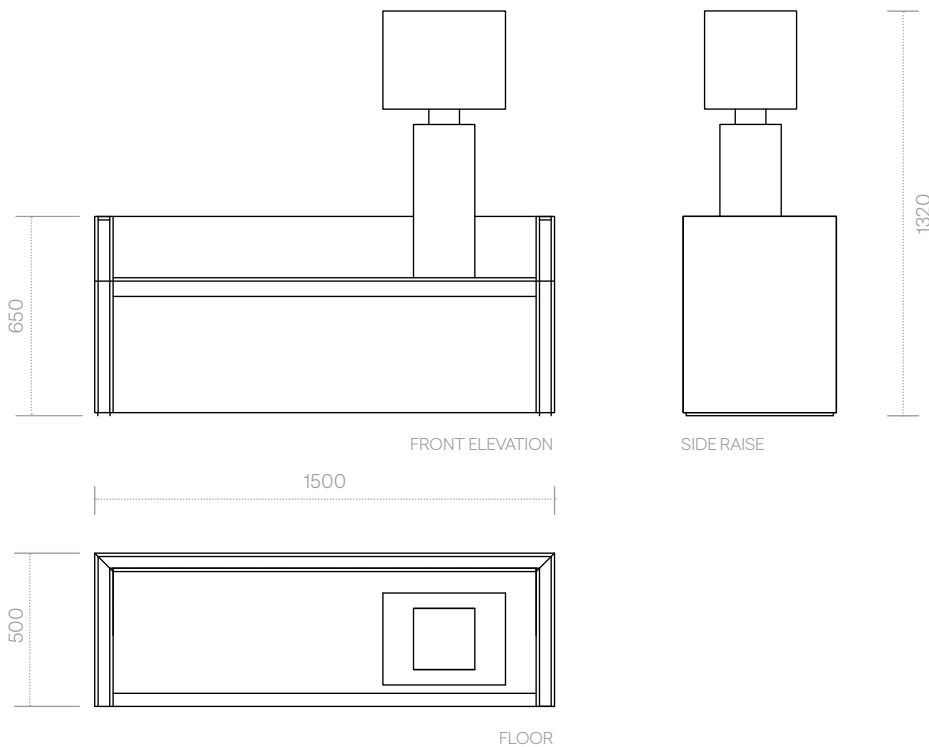

units in mm

Arpa



Arpa®
3486
UMA
with Kèr
finish

H HOMAPAL

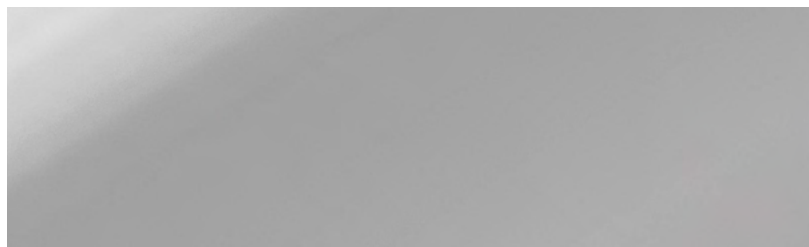

Homapal®
470
Alu Mirror
Polished
Superior
Natural

For this piece, **Arpa®** laminate has been selected in a stone design - 3486 UMA with Kèr finish, combined with a mirror effect aluminium laminate **Homapal®** 470 Alu Mirror Polished Superior Natural.

A combination that fuses the warmth of natural textures with the visual impact of the metallic finish, achieving a balance between elegance and modernity. This selection of materials provides a sophisticated and versatile aesthetic, ideal for projects that seek to stand out for their character and originality.





PRESENTED BY



New Earth

by NACHO ÁLVAREZ

Nacho Álvarez, a designer with more than 17 years of experience in Europe and the Middle East, is a reference in interior design, luxury architecture and project management. As founder and creative director of **Onlyou Design Studio** in Valencia, he fuses a timeless Mediterranean aesthetic with serene and captivating designs.

His approach combines meticulous attention to detail with comprehensive

supervision, transforming ideas into unique experiences. Álvarez personalises each project with his own signature pieces, achieving spaces with a distinctive identity that capture their essence.

Committed to sustainability and experimentation, his work claims a balance between desire, materiality and sensitivity to the environment, establishing a constant dialogue between creativity and responsibility.







New Earth
by NACHO ÁLVAREZ



PRESENTED BY



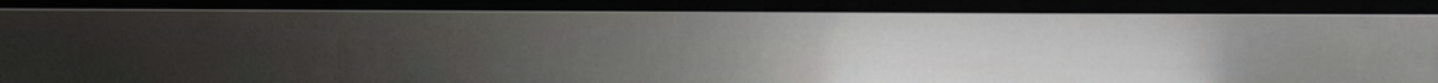
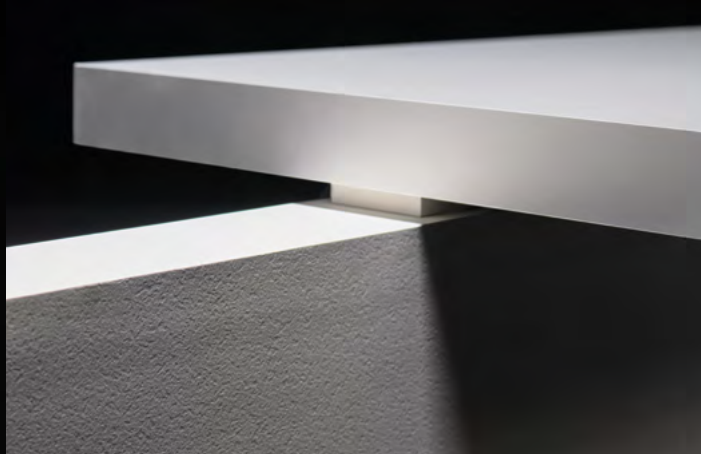



New Earth

by NACHO ÁLVAREZ

— concept

The design of this table transforms the geometry essential for stability into allegory of responsible development, seeking permanence and timelessness. It emerges from technical analysis and merges with artistic invention, reflecting balance and serenity in a changing world. Its essence evokes the cubism of *Braque* and *Picasso*, neoplasticism and constructivism, claiming a progressive abstraction towards straight, horizontal lines. **New Earth** is a visual metaphor for the spiritual harmony of the piece, beyond a simple artistic expression of the author.

— dimensions

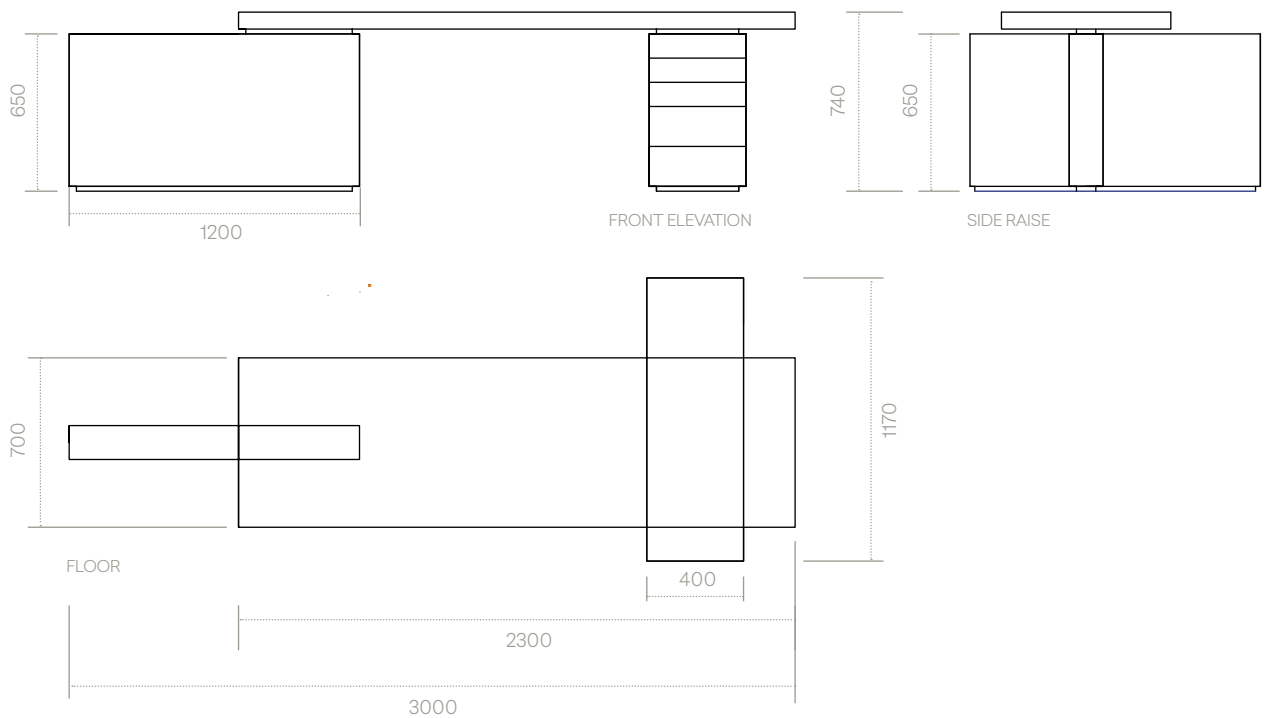

units in mm

Arpa

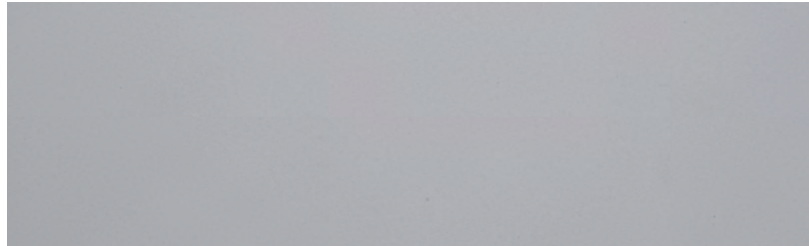

Arpa®
0211
Grigio Perla

HOMAPAL



Homapal®
446
Alu Brushed
Steeltone
SRM

FORMICA



Formica®
Laminate
F9511
Layered
Sand

This design is highlighted by the choice of **Arpa®** laminate in an elegant grey colour, combined with **Homapal®** brushed aluminium metal laminate from the SRM - Scratch Resistant Matt range and a **Formica Group** design featuring a unique sand-brushed finish.

This careful selection of materials creates a perfect balance between desire and stability, bringing character, originality and a sense of permanence to the piece.





PRESENTED BY



Loop

by SIGFRIDO SERRA

With more than 10 years' experience in the Interior Design and Architecture sector, Sigfrido Serra, founder of **Sigfrido Serra Studio**, develops design and interior design projects for companies and private clients, making maximum dedication and proximity his calling card.

Sigfrido Serra Studio's projects are based on the premise of creativity and innovation, projecting the ideal space for the people

who will enjoy it.

Through design, we create elegance and harmony, crafting unique spaces that transform your stay into an experience.

Beyond meeting every need, each space is treated as a living entity, ensuring that each project has its own unique personality.







Loop
by SIGFRIDO SERRA



PRESENTED BY







Loop

by SIGFRIDO SERRA

_ concept

Loop is an element that fuses design, functionality and art. Its versatility allows it to be used as a coffee table, side table or stool, adapting to the modern rhythm. Inspired by the utopian cities of *Miquel Navarro*, its organic forms evoke a continuous flow, while the intense, velvety colours recall the emotions of *Mark Rothko*. The forceful lines reflect the strength of *Richard Serra*. Loop not only solves practical needs, but adds energy to the space, celebrating contemporary design as a bridge between art, creativity and technology in everyday life.

_ dimensions

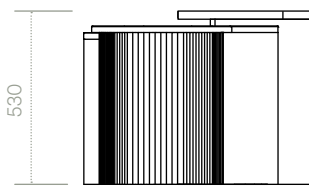

FRONT ELEVATION

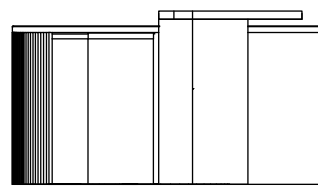

SIDE ELEVATION

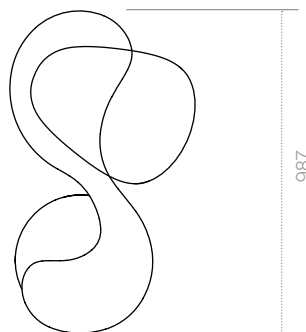

FLOOR



units in mm

FENIX®



FENIX®
0794
Verde
Kitami

FENIX®



FENIX®
0773
Verde
Brac

FENIX®



FENIX®
0790
Viola
Orissa

FENIX® innovative materials take centre stage in a sophisticated combination of two shades of green and a deep dark violet. The choice of this palette seeks to awaken the senses and stimulate the imagination, fusing aesthetics and functionality in perfect harmony. Each shade has been carefully selected to create a visual balance that evokes serenity and sophistication, while highlighting the avant-garde nature of the materials.

The versatility and strength of FENIX® ensure that this proposal is not only visually striking, but also practical and durable, ideal for contemporary projects that aspire to be trend-setting.





PRESENTED BY



Reflejos

by VIRGINIA ALBUJA

Virginia Albuja, Architect Designer and Feng Shui Consultant, specialises in creating spaces that prioritise emotional well-being. With a holistic approach that transcends aesthetics, she designs environments that establish a meaningful connection with those who inhabit them.

In both residential and commercial projects, she adapts each design to the needs and personality of her clients, achieving unique spaces. Her aim is to go

beyond the visual, generating balance, harmony and positive emotional experiences that transform people's daily lives.







Reflejos
by VIRGINIA ALBUJA



PRESENTED BY







Reflejos

by VIRGINIA ALBUJA

— concept

Reflejos is a piece that explores the interconnection between Art, Architecture and Design. Inspired by light and its reflections, it creates a visual effect that transforms any space. Its sculptural base, presented as a work of art in its own right, evokes lightness and dynamism. Each angle and facet has been carefully designed to interact with the light, generating shadows and reflections that enrich the viewer's visual experience.

— dimensions

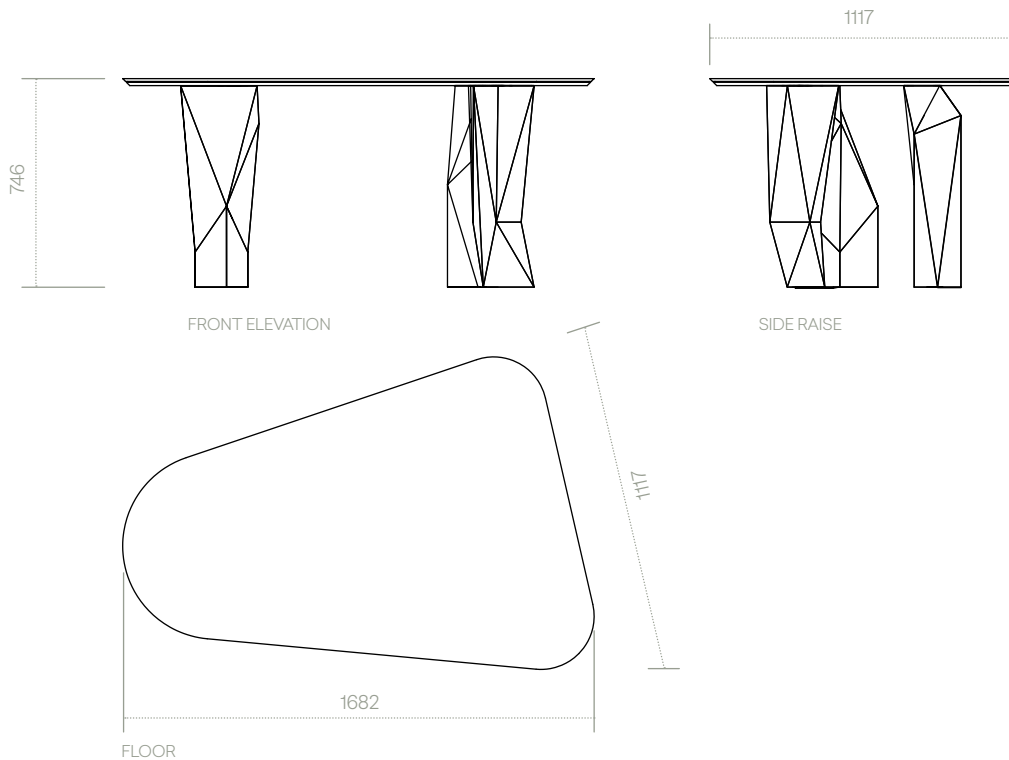

_materias



Homapal®
477
Alu Mirror
Polished
Coppertone

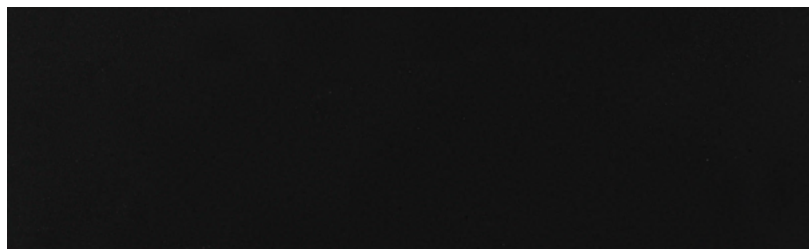

FENIX®
0720
Nero Ingo

For this piece, **FENIX®** materials have been selected for the top and **Homapal®** for the base, a combination that creates a visual harmony that invites contemplation. Together, they achieve a perfect balance between functionality and aesthetics, turning the piece into a unique style statement.

It is a celebration of light, form and texture, designed to inspire and transform any space.



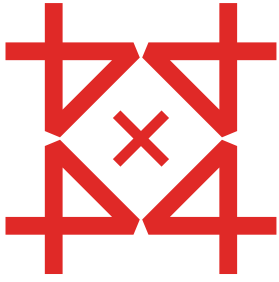

Bringing sustainability to life: durable and renewable surfaces

Since the invention of its high-pressure laminate in 1913, **Formica Group**'s primary objective has been to develop durable products. Durability not only extends the useful life of products, but also minimises the need to replace them, helping to resource consumption and waste generation, thus mitigating their environmental impact.

This approach is central to the circular process towards sustainability.

In addition, the main material of our decorative laminates is sustainably sourced paper, a renewable raw material that reinforces our commitment to a more responsible future.

Characteristics of Formica® Laminate

The basic material used to create our decorative laminates is sustainable paper of natural origin. Laminate (HPL)... It's made of paper!

To make our renowned Formica® Laminate, the Kraft paper, which forms the core of the material, is resin impregnated and pressed at high pressure and temperature with a resin impregnated "decorative" paper, which not only adds colour and aesthetics to the surface, but also provides high resistance to wear, impact, heat and staining.

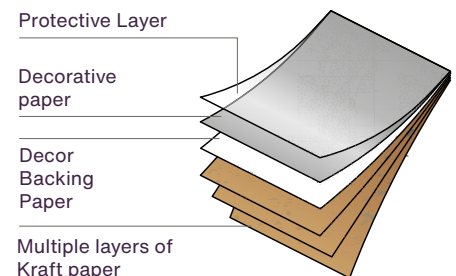

This creates the completely sealed and resistant hygienic surface we are all familiar with.



Where to buy this series

The furniture in this catalogue is available at **Moblitte.com**

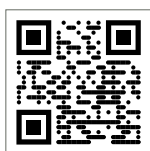

moblitte
design your world

Tailor-made production

The furniture is made to measure, up to the maximum and limited number of pieces of each design: 16 units, as it is a numbered and exclusive series.

For further information, please do not hesitate to contact **Moblitte®**.

Formica Group is not responsible for any processing of any such purchase, which is the responsibility of **Moblitte**.

4 series

4 top designers

16 exclusive pieces



Disclaimer

General

The information provided by Formica Group ("Formica") in this document is solely indicative. The information given in this brochure is correct at the time of publication. However, as we have a policy of constant product development and improvement, product specifications may change in the future. Visit formica.com, or formica.info for technical data, as the most up-to-date source of information. Formica does not warrant that the information in this document is suitable for your specific purpose. Colour system notations represent the closest match available in the particular system. They may or may not be exact and are provided for guidance only. When exact colour information is required, please always refer to an actual laminate sample in the specified finish.

Liability

Formica is not liable (neither contractual nor non-contractual) for any damage arising from or related to the use of this document, except if and to the extent that such damage is the result of willful misconduct or gross negligence on the part of Formica and/or its management. The limitation of liability applies to all parties affiliated with Formica, including but not limited to its officers, directors, employees, affiliated enterprises, suppliers, distributors, agents and representatives.

General Conditions

All sales of Formica® brand products are governed by the Formica General Terms and Conditions of Sale in effect at the time of sale and contained in every order acknowledgement and are available upon request.

Intellectual Property

All intellectual property rights and other rights regarding the content of this document (including logos, marks, text and photographs) are owned by Formica Group and/or its licensors. Formica, and the Formica Anvil Device are registered trademarks of The Diller Corporation. © 2025 The Diller Corporation



formica.com