

Espai Formica Group®

a place to belong

Nau Bostik

*Carrer Ferran Turné, 1-11, Barcelona
From 9th-16th of June 2022*

ESPAI FORMICA GROUP, a place to belong, is a collaborative academic/professional project for the company Formica Group, developed between Elisava Barcelona School of Design and Engineering and the Rhode Island School of Design, and led by the Madrid and New York based design studio müsing –sellés.

Formica Group is a leading provider of branded, designed surfacing solutions for commercial and residential customers worldwide. As the world's largest manufacturer of High Pressure Laminate (HPL), their international network of design, manufacturing, distribution and sales operations maintains the recognition of Formica® as a global brand. Working closely with architects, designers, fabricators, specifiers and developers, the company is strategically positioned to offer new products and surfacing solutions that complement current design trends. Their ongoing product design and development process underpins our commitment to innovation.

The space ESPAI FORMICA GROUP has been designed entirely with Formica® high-pressure laminates, enhancing the versatility and capacity of the material to create multipurpose atmospheres and architectural spaces. Through the combination of metallic finishes and a vivid monochromatic finish, a space full of nuances and contrasts challenging what collective belonging means within Barcelona.

formica.com



re-activating existing space

Project Site

Within the framework of the “New European Bauhaus” initiative for more inclusive, sustainable and enriching living opportunities, the campaign seeks to question the ability of both public and private collective spaces. It also questions the ability to adapt to a changing society, and contribute to a new common sense of space, therefore creating a collective sense of belonging. ESPAI FORMICA GROUP is set in the dynamic social and cultural center of Nau Bostik, an old industrial complex now used as a space for artistic creation. The project aims to reactivate sites of Barcelona to create decapitalised space, by deforming the spatial conditions of the 250 sqm nave where the project takes place and assigning a new use.

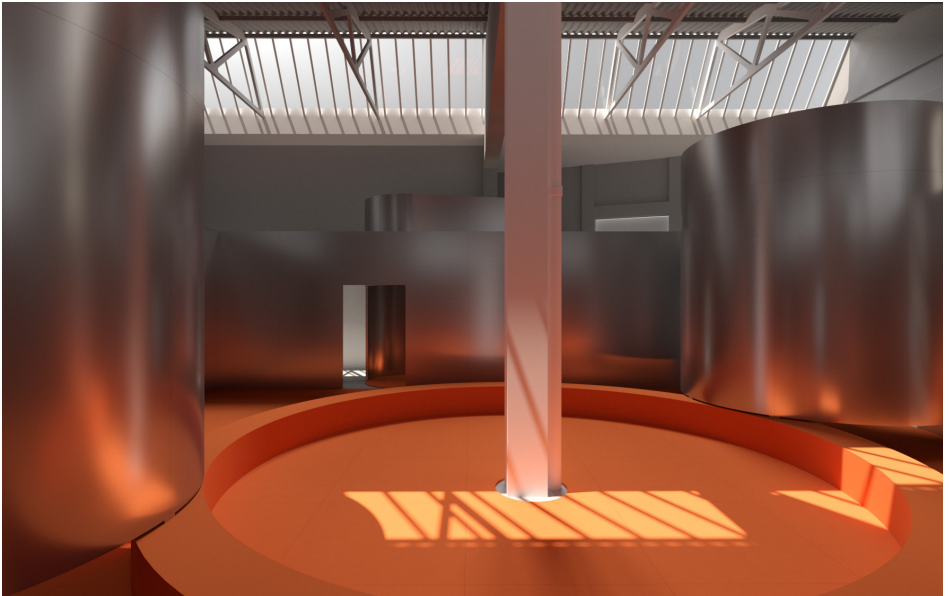

stage for action

Design Concept

The project is an ephemeral architectural intervention that reactivates one of the warehouses within the Nau Bostik complex through a de-capitalised, de-hierarchised, and inclusive space for collectivity. The reactivation is carried out through a sequence of spaces in which coexistence is prioritised, evoking a new sense of collective domesticity.

The spatial articulation came from the decision of acting upon the site with a perimeter that responds to it's components, by assigning the perimeter the action of a central collective space and four different programmed smaller spaces called rooms.

The rooms along the interior of the perimeter offer immersive collective interaction, while the rooms along the exterior are for more general learning about the project and its collaborators. The use of audiovisual and sensory installations throughout the project evoke further collective interaction between the site and its users.

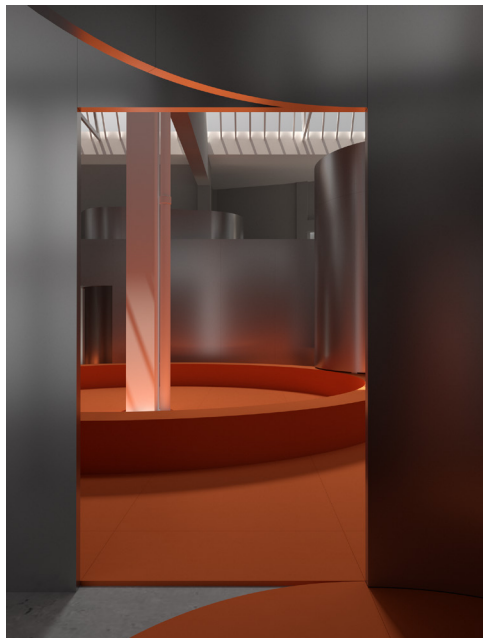

architecture as a communication tool

Technical Information

As the project is made entirely out of Formica® laminates, many studies were developed prior to the final results to explore the technical capacity and sustainability of Formica Group's products. Creating panels that are the full size of the Formica laminate helped in ease of construction and less material waste.

For visual hierarchy of the spatial sequencing, the smaller rooms for domesticity and learning have taller walls than the central collective space. The project uses several Formica laminate materials: Brushed Aluminium for the vertical surfaces, Clementine for all horizontal surfaces including furniture, and Aluminium Crush for the exterior ceilings. The rooms on the interior are fully covered in Clementine, creating an immersive environment with the material.

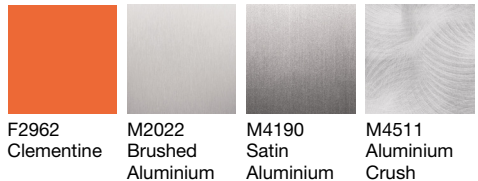
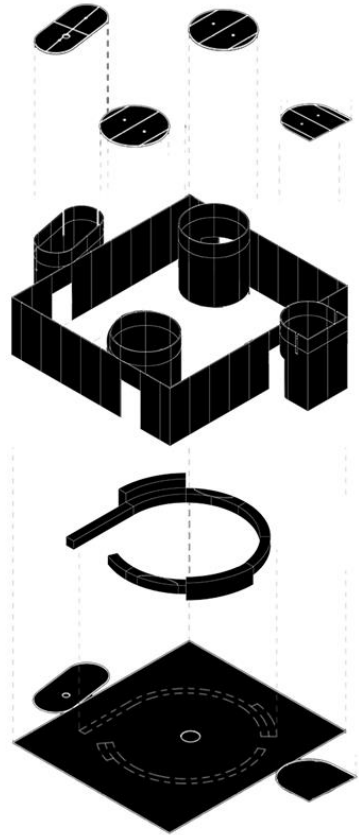

space for collective *experience*

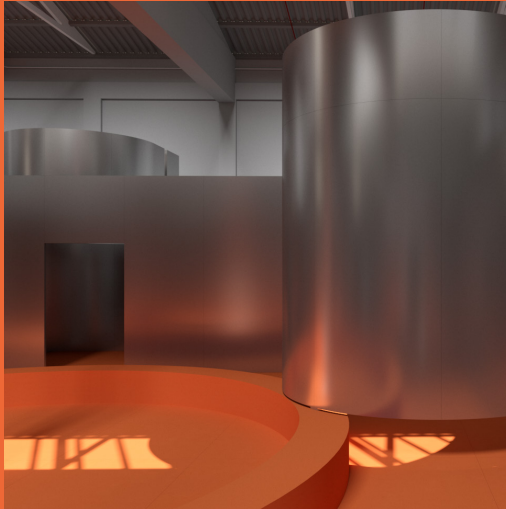

The central room invites collective gathering, the large circular bench provides opportunities for open discussion, presentation, and a place to rest. Placed in the centre of the site, each part of this bench is movable, in order to create a dynamic, collective space. The bench touches the two interior collective rooms, creating a physical connection between all intimate collective spaces of the intervention.

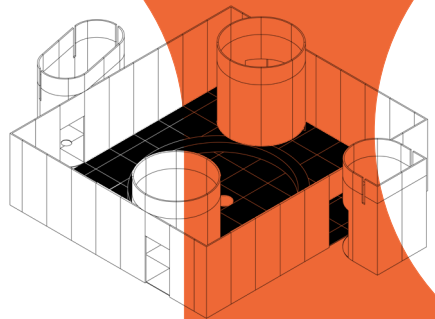

rooms for collective *domesticity*



The rooms for collective domesticity are both located inside the perimeter. The rooms include tables and chairs, for people to gather, converse and learn more about Formica Group's products. To react and respond to the perimeter, the table's connecting chairs are combined to form a single cylinder. The goal of these spaces is to harness the community and elevate conversation and community building.

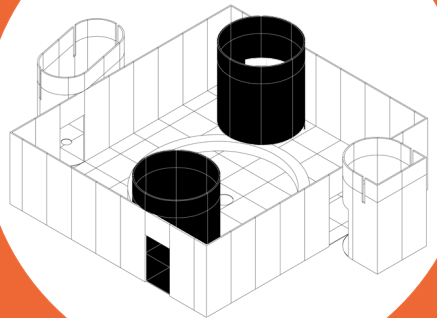

rooms for collective *learning*



Located near the entrance to introduce visitors to the space, the booklet room showcases pamphlets designed by our students that features our design processes, images, and project background. The projection room features visual media and audio related to our design process at corresponding schools and our partnership with Formica Group. The tiered seat aims to optimise the space and viewing experience.

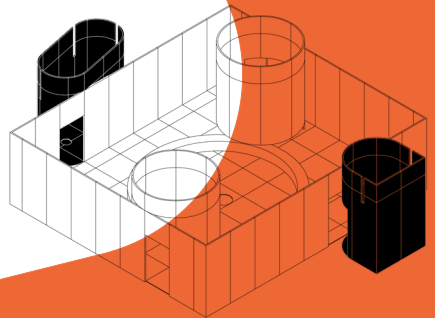

Team

Elisava

Mar Gené

Claudia Anguera Marti

Aina Esquirol

Emma Fifield

Cristina Chenxi Pan Liu

Eulalia Sala

Qiong Wu

RISD

Grace Barrett

Gunju Kim

Jianang Wu

Natalia Silva

Qyu-Ri Kim

Rada Singhasaneh

Shreya Khanna

Vedika Khushalani

müsing –sellés

Álvaro Gómez-Sellés

Marisa Müsing

Formica Group

Gema Bonilla

Luismi Iburguren

Fabrication & Installation

PDV Wood

Nau Bostik

Carrer Ferran Turné, 1-11

08027 Barcelona

A project by

 ELISAVA



Led by



For



In the framework of



Fabricated by

