

APPLICATION *perspectives*

Healthcare Environments

The Formica® Portfolio of Surfacing Solutions has a long history of delivering reliable, high-performance solutions in demanding environments.

This brochure highlights materials suited for today's clinical settings – from patient areas and nurse stations to labs and receptions. The Formica® Portfolio of Surfacing Solutions brings together a broad range of designs, colors, and textures that support durability, cleanability, and visual comfort. With coordinated options across multiple materials, the Formica® Portfolio of Surfacing Solutions offers a dependable, single-source solution for healthcare facilities.

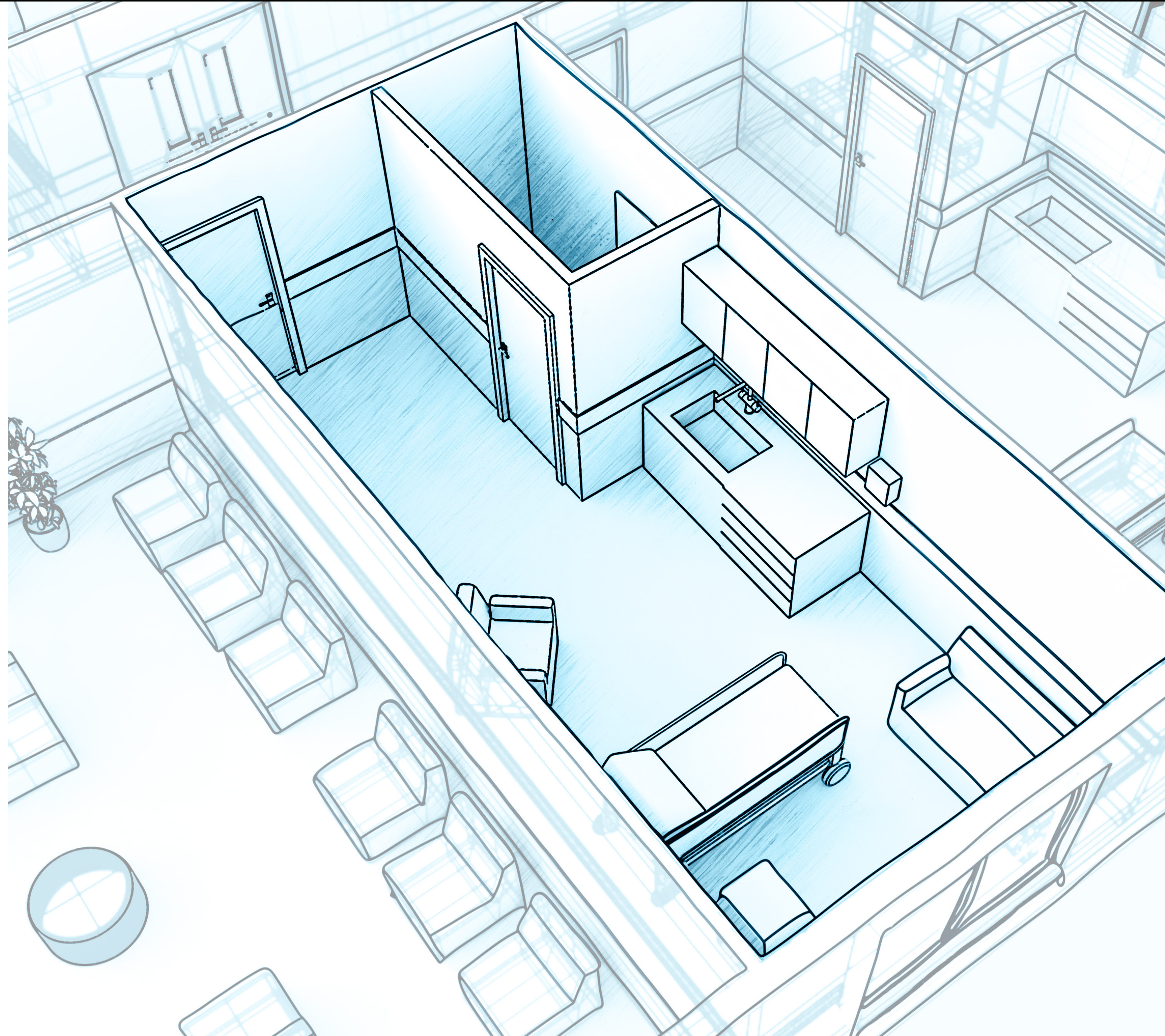

Reception

Reception areas shape the first moments of the patient experience, offering comfort and reassurance from the start. These high-touch spaces need materials that feel welcoming while standing up to everyday wear and frequent cleaning. The Formica® Portfolio of Surfacing Solutions provides durable, easy-to-maintain options in coordinated colors and textures, helping create reception environments that look inviting and support the care delivered within them.

A welcoming first impression powered by surfaces that deliver durability, cleanability, and everyday resilience.

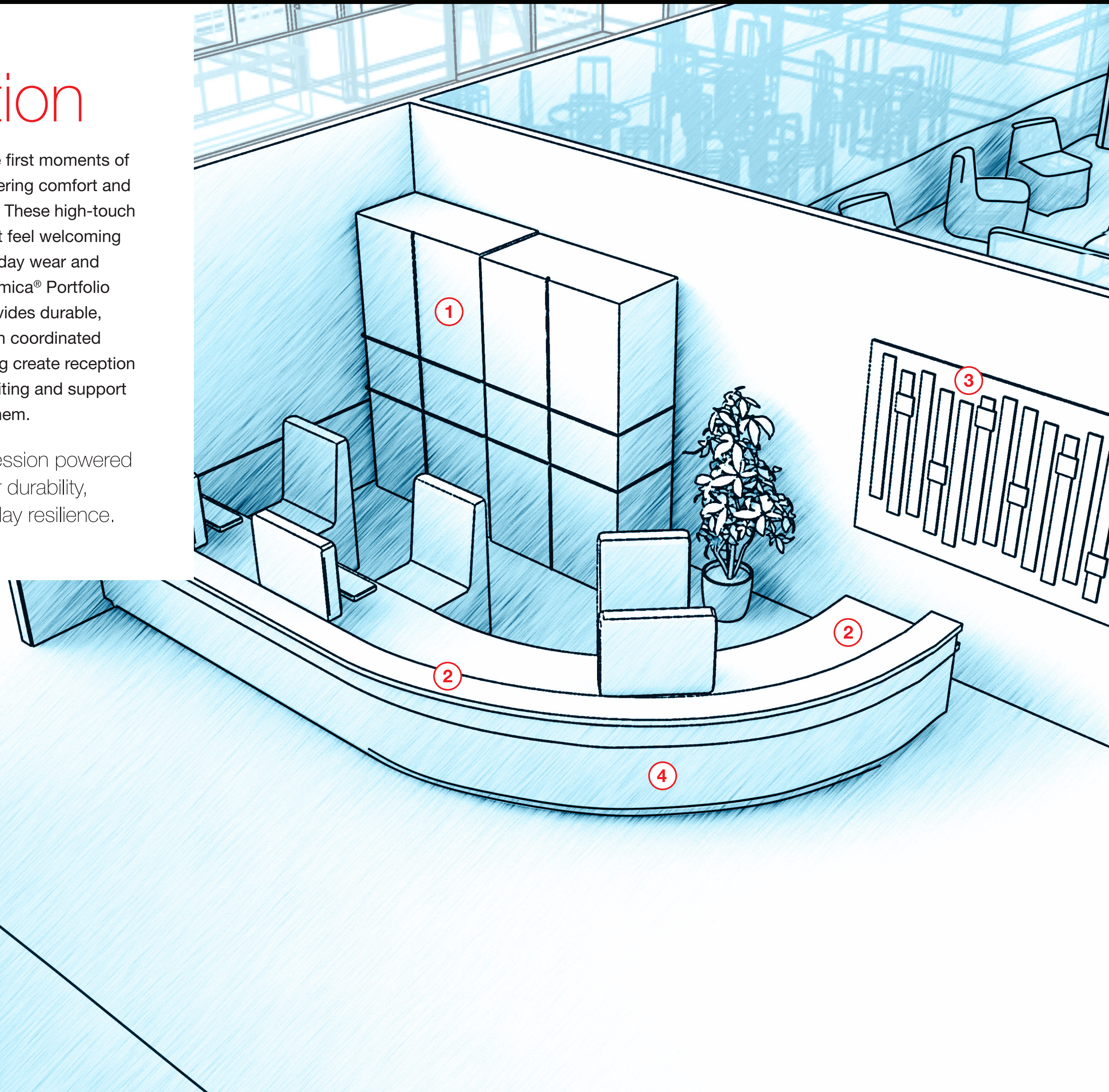

1 Casework behind the reception desk benefits from materials that balance a clean, modern look with everyday practicality. **FENIX®** Innovative Materials offer a soft-touch, extremely matte surface that resists fingerprints and scratches.

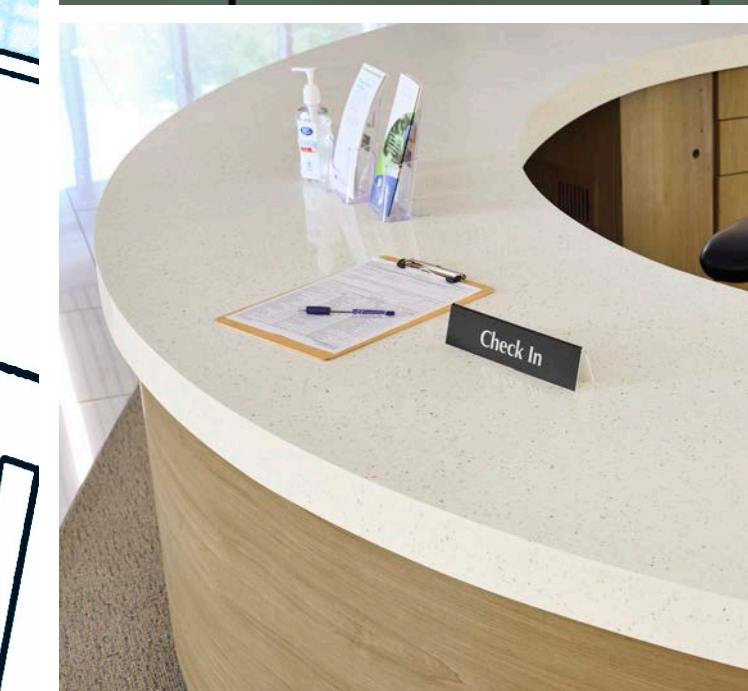

2 With its seamless, nonporous construction, **Everform® Solid Surface** resists moisture, stains, and wear - ideal for high-traffic reception desks. The material maintains a clean, professional appearance while supporting the industries rigorous healthcare cleaning protocols.

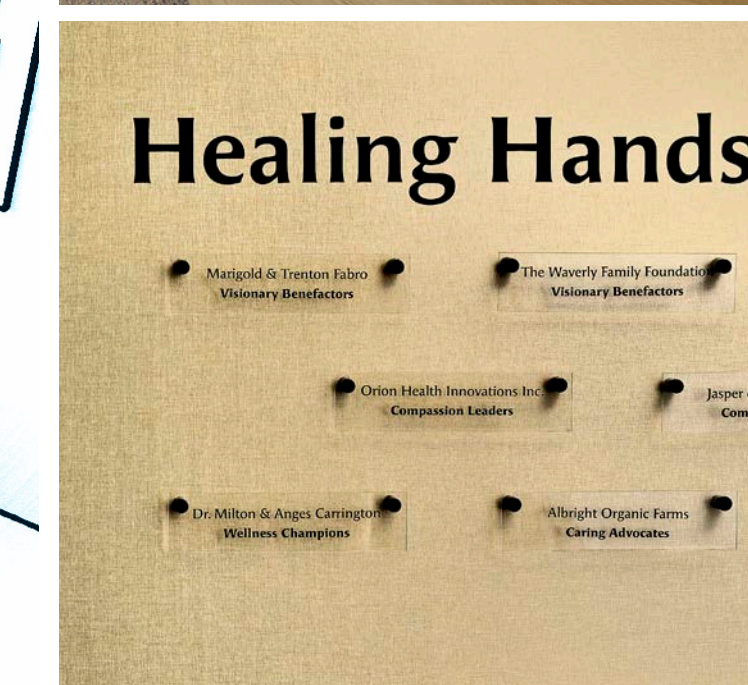

3 In areas dedicated to donor recognition or memorial features, premium, visually distinguished materials are essential. **Homapal®** Metals provide the richness of real metal and the durability needed to honor these spaces with clarity and respect.

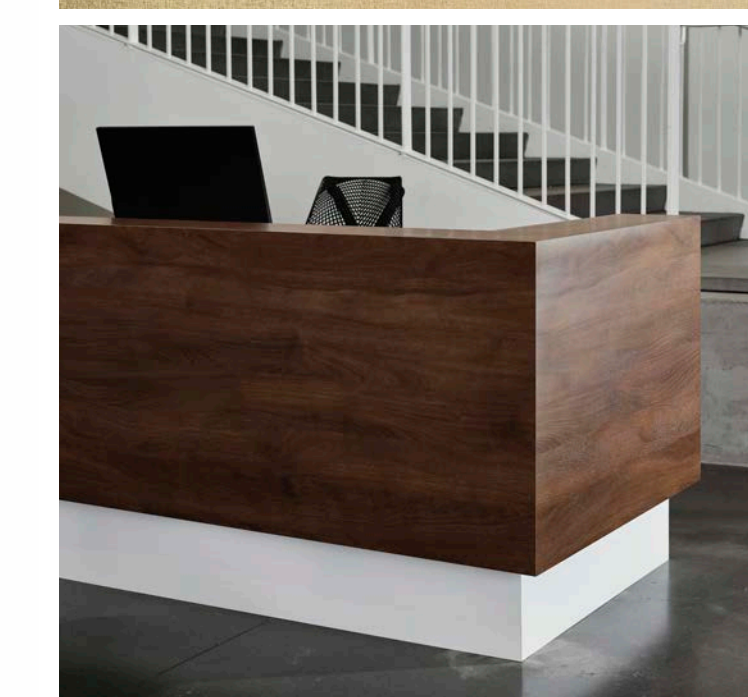

4 With its rich texture and depth, **InDepth Surfacing™** enhances the reception desk front with a look that feels both modern and inviting. The material offers durable, easy-to-clean performance suited to the high-touch demands of healthcare environments.

Nurses Station

Nurses stations serve as the busy heart of a healthcare unit, supporting constant activity, communication, and patient interaction. These hardworking spaces require materials that remain dependable throughout the day and support regular cleaning protocols. The Formica® Portfolio of Surfacing Solutions offers coordinated options built to handle continuous use while contributing to an environment that supports focus, efficiency, and compassionate care.

A focused, efficient care space strengthened by materials that deliver durability, cleanability, and dependable performance.

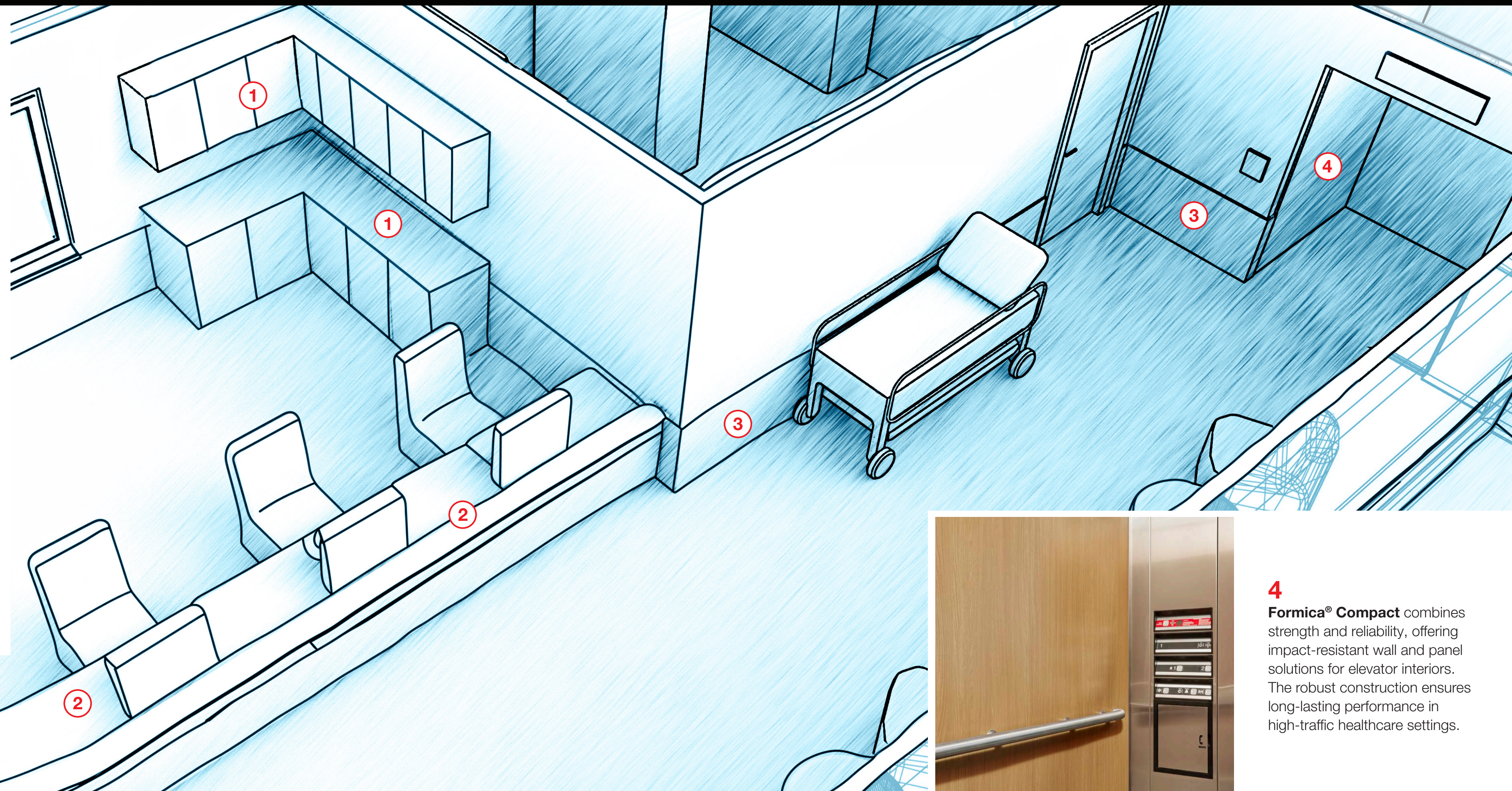

1 For casework that supports a busy nurses station, **ColorCore®2** keeps cabinetry looking fresh and cohesive. Its color-through construction helps the space remain visually organized and professional throughout the day.

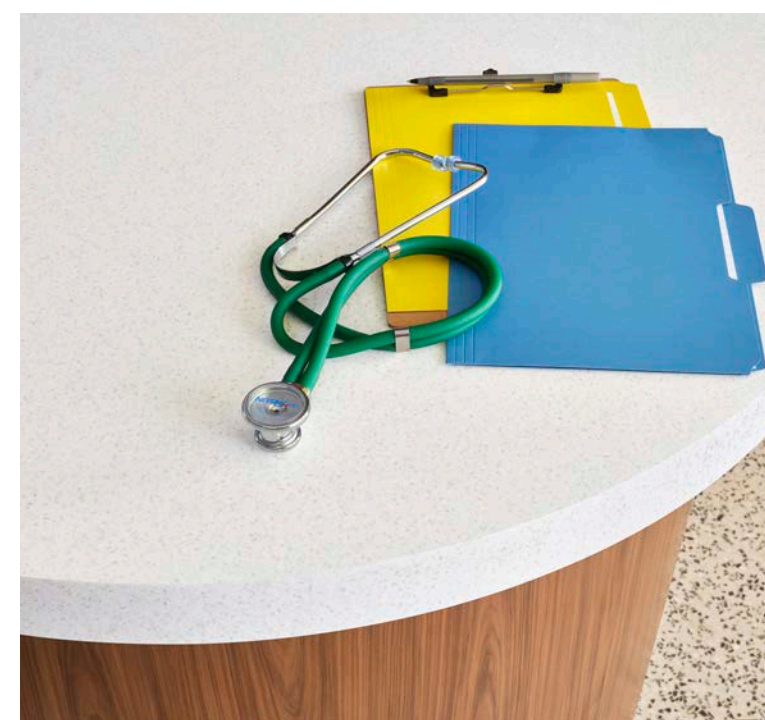

2 At a nurses station where care never pauses, **Everform® Solid Surface** provides a countertop solution that's easy to clean and built to last. Its dependable finish supports both the workflow and the people behind it.

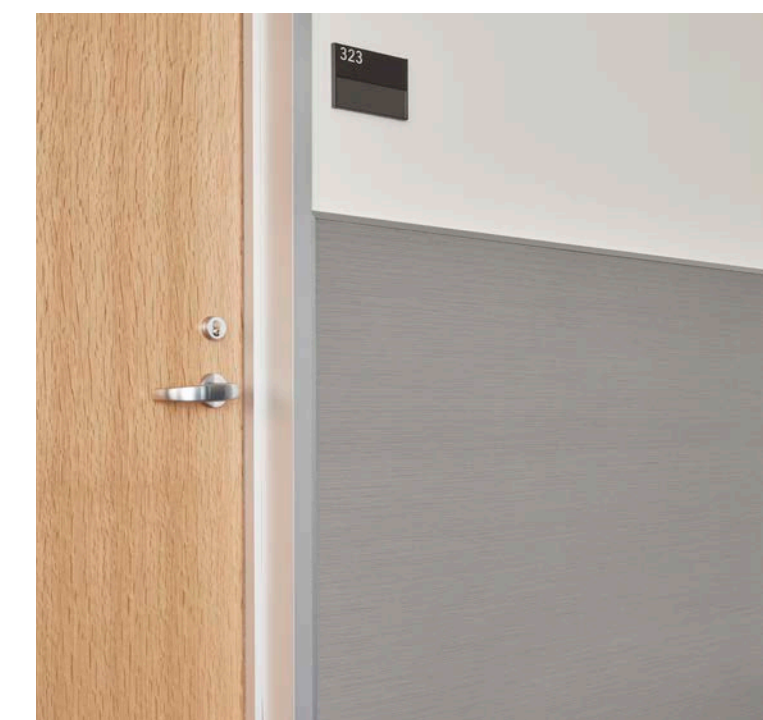

3 In healthcare hallways, where walls face constant traffic, **HardStop®** delivers unmatched durability and cleanability. Its impact-resistant surface keeps corridors looking professional and cared-for.

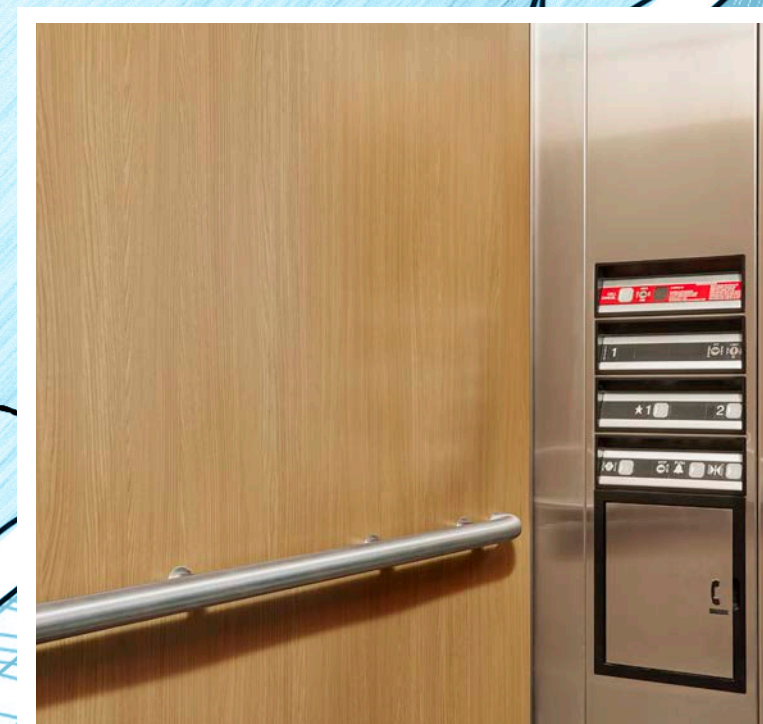

4 **Formica® Compact** combines strength and reliability, offering impact-resistant wall and panel solutions for elevator interiors. The robust construction ensures long-lasting performance in high-traffic healthcare settings.

Patient Room

In patient rooms, every surface matters. From countertops to cabinetry, materials must withstand daily wear while supporting hygiene and safety standards. The Formica® Portfolio of Surfacing Solutions provides dependable surfaces that help create a clean and supportive environment for patients and caregivers alike.

A supportive environment built on durable,hygienic surfaces that hold up to constant care.

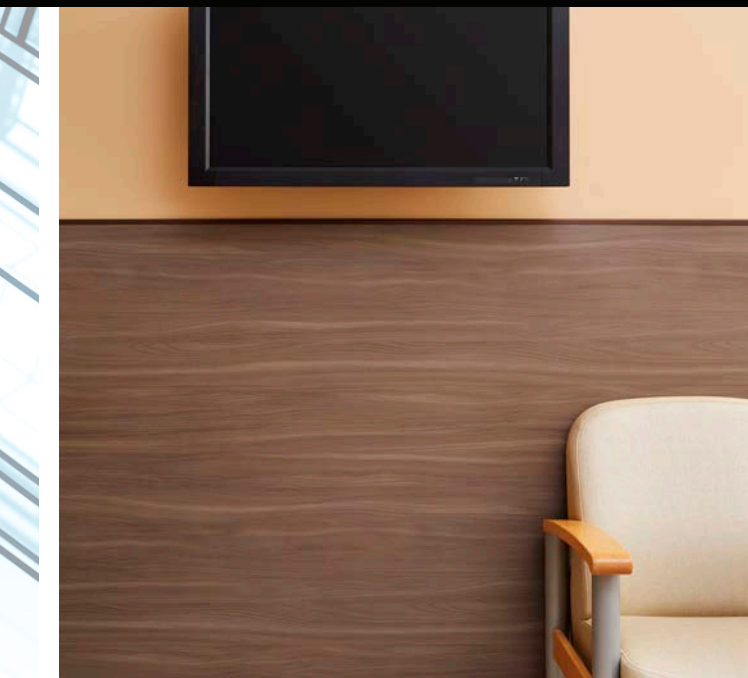
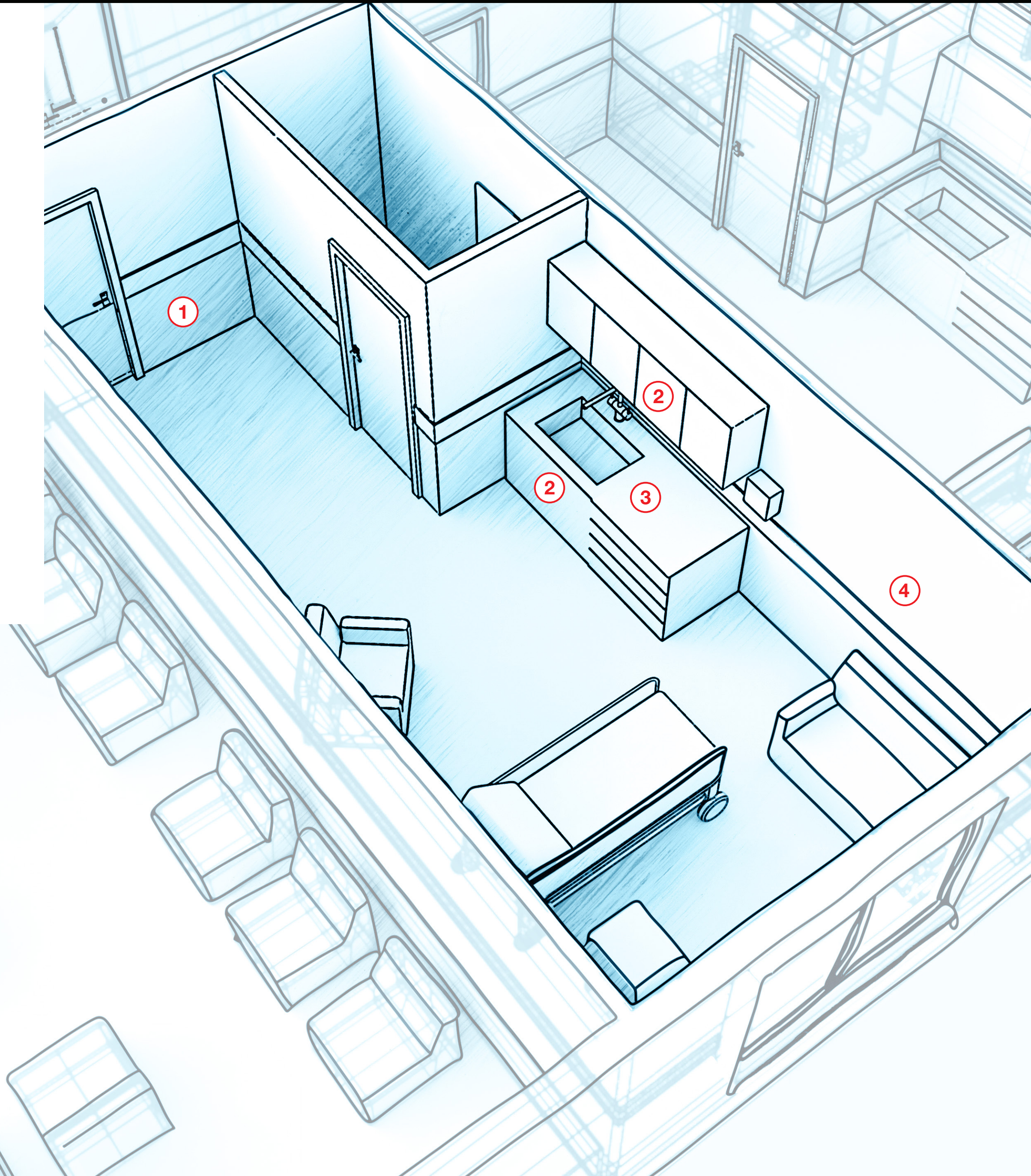

1
In patient rooms, **HardStop®** shields walls from impact and daily activity, helping maintain a clean, cared-for environment for patients and staff.

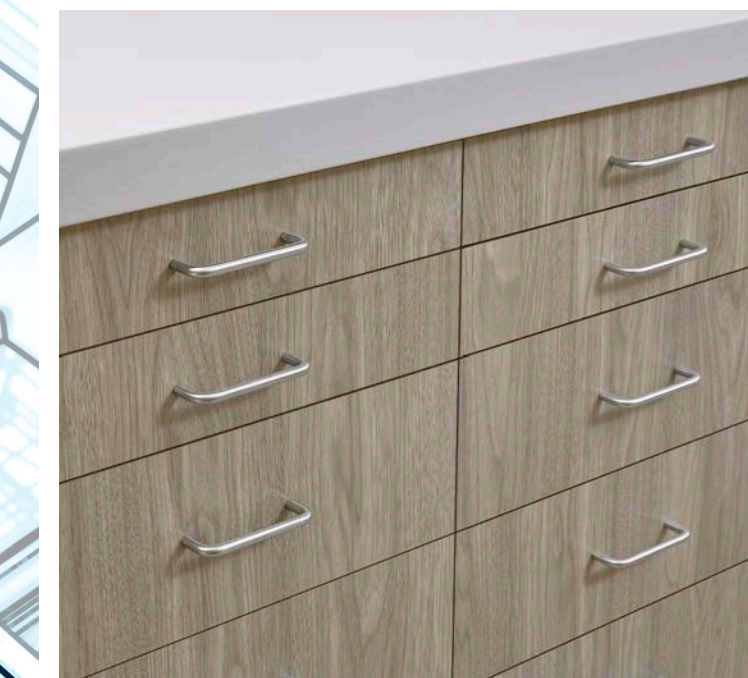

2
Durable, hygienic, and dependable, **Formica® Laminate** keeps cabinetry performing day after day.

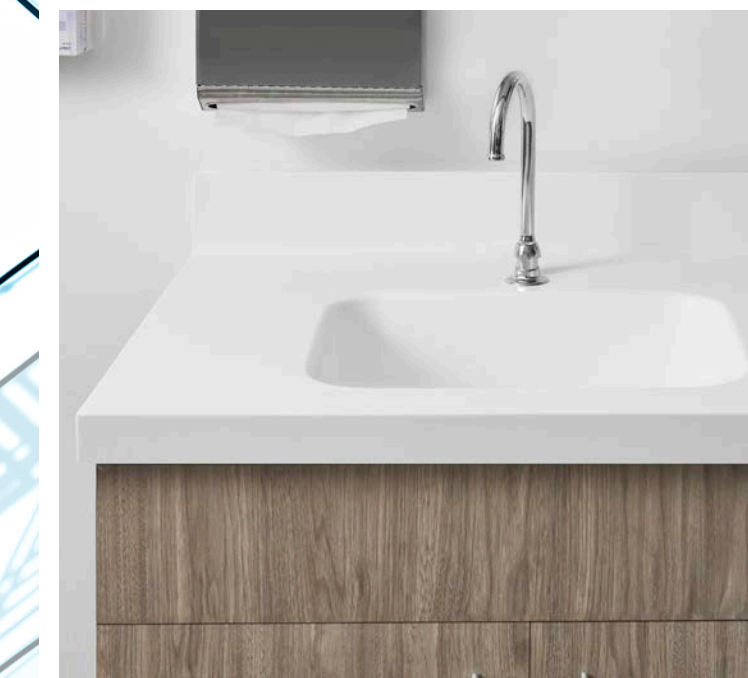

3
Patient room countertops take center stage in daily care. **Everform® Solid Surface** with a seamless, integrated sink provides a smooth, nonporous surface that supports hygiene and easy cleaning.



4
Durable, hygienic, and fully customizable, **Formica Envision™** supports graphics that bring warmth to pediatric rooms and other healthcare spaces. Surfaces remain easy to maintain while enhancing the patient and visitor experience.

Laboratory

Laboratory environments, from blood draw suites to diagnostic and pharmaceutical labs, handle some of the most sensitive and essential work in the care journey. The Formica® Portfolio of Surfacing Solutions offers materials designed to meet these needs, providing durable, cleanable options that help teams work efficiently and safely.

Materials built to keep laboratory spaces clean, dependable, and ready for every test.

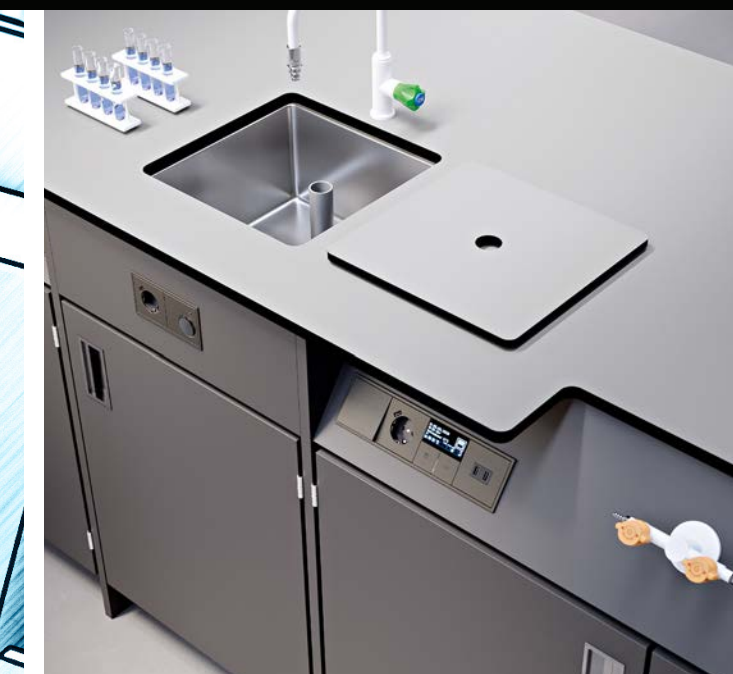

1
Suitable for areas where physical durability is key, **Trespa® TopLab® Base** offers a high resistance to scratches, impact, and daily wear. Its robust surface makes it a dependable choice for worktops in testing and processing areas.



2
Designed for the most demanding lab environments, **Trespa® TopLab® Plus** and **Plus Align** provide strong chemical resistance, and hygienic smooth surfaces required in healthcare, pharma, and clean lab settings. Their closed, high-performing surface supports consistent worktop performance, even under intensive use.



3
Trespa® TopLab® Vertical features 1 hour contact chemical resistance and the same durability as its worktop counterparts, making it well suited for wall lining, cabinet faces, casework, and service areas in healthcare labs. Its smooth, closed surface supports consistent hygiene and cleanability.



4
Everform® Solid Surface provides a smooth, nonporous option for window sills within healthcare settings, resisting moisture and supporting frequent cleaning. Its durable construction helps these high-touch areas stay hygienic and well maintained.

Cafeteria

Healthcare cafeterias and food-service areas rely on surfaces that meet strict standards for sanitation, durability, and continuous use. With NSF food-safe options and a range of durable, easy-to-clean materials, the Formica® Portfolio of Surfacing Solutions supports spaces that must perform reliably through every meal service.

Reliable, cleanable surfaces that keep cafeterias operating smoothly.

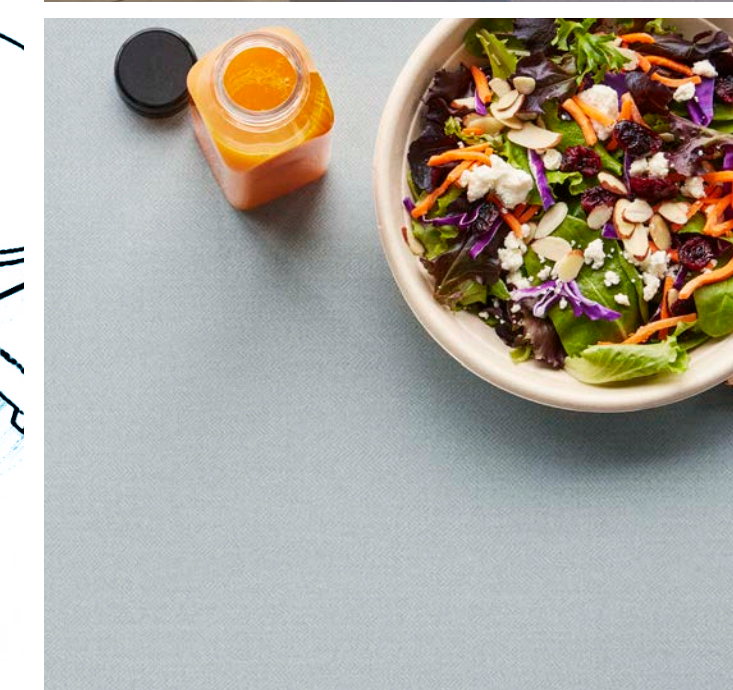
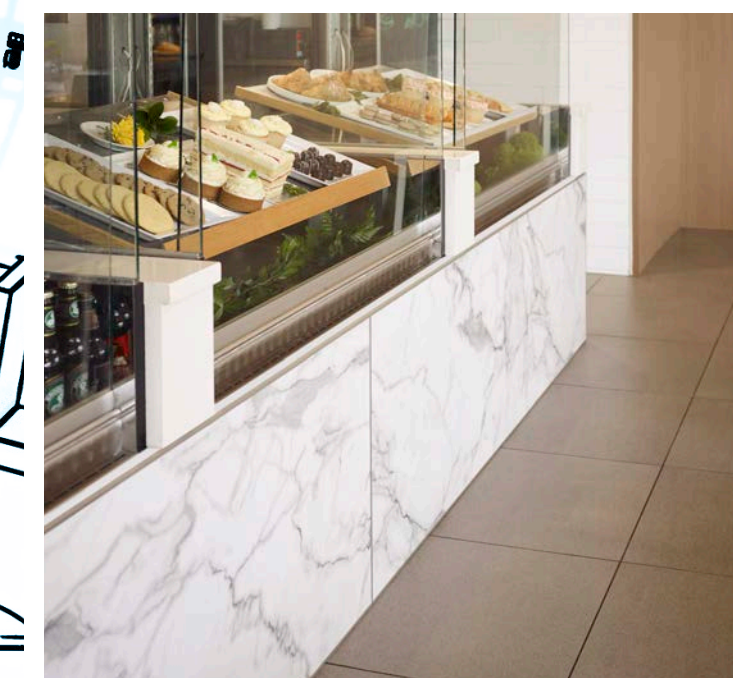
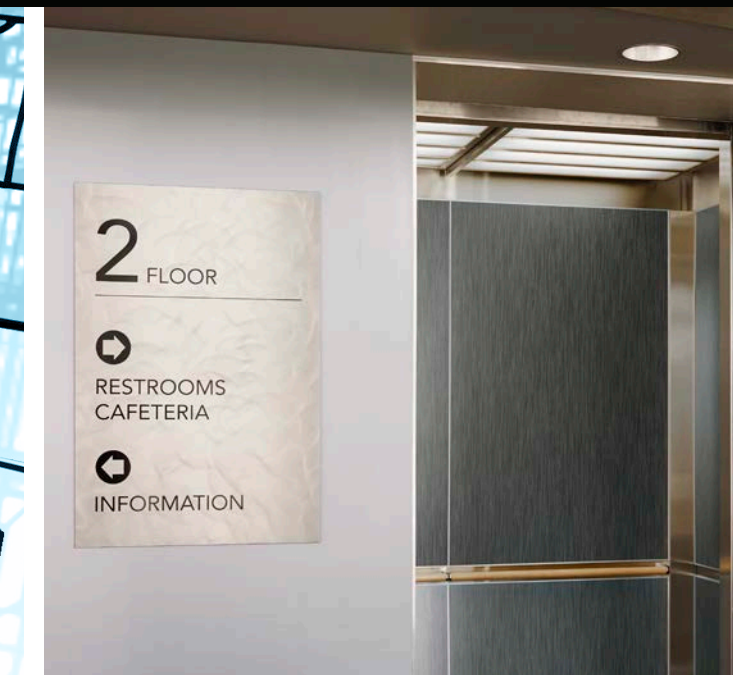

1 Homapal® Metals elevate cafeteria and service-area signage with authentic metal textures that feel modern and clean. Their resilient surfaces work well for branding panels, menu displays, and decorative touches, bringing visual interest without compromising durability or maintenance needs.

2 Front-of-house areas in healthcare cafeterias benefit from surfaces that feel warm and inviting without sacrificing performance. **180fx®** offers realistic, large-scale visuals with the durability and easy maintenance needed to support a clean, comfortable experience for patients, visitors, and staff.

3 Perfect for high-traffic food-service areas, **Everform® Solid Surface** resists stains, moisture, and wear while offering a smooth, seamless surface that simplifies sanitation. Its range of colors and patterns brings both practicality and polished design to healthcare dining spaces.

4 **Formica® Laminate** provides durable, easy-to-clean surfaces for café tables and bar-height counters in healthcare cafeterias. Available in the **Formica® Laminate Antimicrobial Collection**, it helps maintain hygienic dining areas without sacrificing style.

Product	Overview	Recommend Applications	Features and Benefits	Certifications
Formica® Laminate	Formica® Laminate* is a high-pressure decorative surfacing material engineered for durability, versatility, and design flexibility. It offers a broad range of solid colors, woodgrains, patterns, and textures to support performance-driven design across varying budgets. Ideal for horizontal and vertical interior applications in commercial and healthcare environments.	Countertops Cabinets and casework Tables and furniture Doors and partitions	Widest range of design, color, textures and gloss level options Scratch, wear and impact resistance Ease of fabrication Ease of cleaning and maintenance Postformable Nonporous, hygienic	NSF Certified Greenguard Gold - Indoor Air Quality Certified® LBC Red List Approved USDA Biopreferred - 72% EPD® and HPD™ FSC® Certified
Everform® Solid Surface	Everform® Solid Surface is a non-porous, homogeneous material engineered for seamless fabrication and long-term durability. Its resistance to moisture, stains, and bacteria makes it well suited for clinical, food service, and high-use commercial environments. The material thermoforms easily for integrated sinks, backsplashes, and custom features with minimal visible seams.	Countertops Sinks Reception desks Nurses Station Cafeteria Window sill	Design flexibility: wide range of design options Seamless design Durable and wear resistant Nonporous, hygienic Thermoforming capabilities Water resistant Ease of cleaning and maintenance Renewable and repairable	NSF Certified Greenguard Gold - Indoor Air Quality Certified® LBC Red List Free** Class 1/A Fire-rating EPD®
HardStop® Wall Protection Panels	HardStop® Decorative Wall Protection Panels are engineered with a treated fiberglass core for enhanced impact, scratch, and fire resistance. Designed for fast, efficient installation, they provide Class A fire performance and long-term wall protection in demanding environments. Panels are available in coordinated Formica® laminate designs for integrated interior systems.	Wainscot Wall panels Column wraps Room dividers Counter/desk fronts Backsplashes Must be applied to standard white drywall only	Wide range of options in design and color Scratch, stain and water resistance Chemical resistance Easy fabrication and installation Ease of cleaning and maintenance Coordinating seam treatments available Available in Formica Envision™ HardStop®	NSF Certified Greenguard Gold - Indoor Air Quality Certified® Class 1/A Fire-rating EPD® and HPD™ ANSI/NEMA LD3-2005 Compliant SEFA 8.1 Approved ASTM G22 - Bacterial Growth Resistance
TRESPA® TopLab®	TRESPA® TopLab® is a compact high-pressure laminate developed specifically for demanding laboratory and technical environments. Due to the Electron Beam Cured acrylic surface, it delivers exceptional chemical, moisture, scratch and impact resistance with consistent surface performance. Available in a wide range of colors and thicknesses, it supports work surfaces, casework, wall linings, and partitions across healthcare and education facilities.	Laboratory worktops Laboratory casework Laboratory wall lining Elevator cabs (Vertical only)	Chemical resistance Impact resistance Ease of cleaning and maintenance Does not support bacterial growth Suitable for contact with food (Plus/Plus Align) Smooth machinability Scratch and wear resistant Quick installation 10-year warranty	Greenguard Gold LBC Red List Approved (Plus Align) USDA Biopreferred 59-86% SEFA 3 (Plus/Plus Align) SEFA 8 (Base/Vertical) EPD® and HPD™ FSC® Certified
FENIX® Innovative Materials	FENIX® is a next-generation surface material engineered with advanced acrylic resins and Electron Beam Curing technology. It features an ultra-matte appearance, soft-touch feel, low light reflectivity, and built-in anti-fingerprint resistance. Thermal healing technology allows superficial micro-scratches to be repaired, making it ideal for high-touch interiors.	Countertops Cabinets and casework Tables and furniture	Soft touch Extremely matte Resists fingerprints Nonporous Low light reflectivity Thermal healing of microscratches is possible	NSF Certified Greenguard Gold EPD® and HPD™ FSC® Certified
Homopal® Metal Laminates	Homopal® Metal Laminates combine real aluminum, copper, brass, and stainless steel foils with high-performance laminate construction. Advanced embossing and finishing techniques create distinctive textures. These laminates are ideal for vertical installations like feature walls, casework, signage, and integrated magnetic applications.	Feature walls Decorative casework Signage Magnetic applications	Wide range of designs and patterns Consistency of material quality and visual Ease of fabrication Ease of cleaning and maintenance Artisan craftsmanship Magnetic and magnetic markerboard options available Several solid metal decors available	Greenguard Gold - Indoor Air Quality Certified® Class 1/A Fire-rating EPD® and HPD™ FSC® Certified (Metal Laminates only)

*Available as antimicrobial (not available in Canada)

**Domestic patterns only

Product	Overview	Recommend Applications	Features and Benefits	Certifications
Formica Envision™	Formica® Envision™ is a digitally printed laminate that allows for fully customized imagery without sacrificing laminate performance. Printed designs are sealed within a durable, cleanable surface suitable for high-traffic interiors. It is commonly specified for branded environments, feature walls, and wayfinding applications.	Custom decorative spaces like: Countertops Cabinets and casework Tables and furniture Walls and doors Murals Signage Restroom partitions	Custom graphics One sheet minimum order Durable Ease of fabrication Ease of cleaning and maintenance	NSF Certified Greenguard Gold - Indoor Air Quality Certified® - Children & School Certified ANSI/NEMA LD3-2005 Compliant
InDepth Surfacing™	This innovative product category incorporates the latest technology to create a synchronized, embossed matte texture with light-reflecting details. The resulting high-performance laminate surfaces draw the eye with luxe metallic elements, real wood veneer visuals and textural realism.	Reception Desks Countertops Cabinets and casework Tables and furniture Doors and walls Columns and partitions	Synchronized embossed texturing and pearlescence highlights for exceptional realism Scratch, wear and impact resistant Ease of fabrication Ease of cleaning and maintenance Postformable	NSF Certified Greenguard Gold - Indoor Air Quality Certified® FSC® Certified
ColorCore®2	ColorCore®2 Laminate can be used in highly creative ways to transcend their fundamental practicality. Now more versatile than ever, ColorCore®2 Laminate offers an assortment of inspiring solid colors and patterns that go all the way through—so there’s no dark edge.	Countertops Cabinets and casework Tables and furniture	Solid color-through core Scratch, wear and impact resistant Ease of fabrication Ease of cleaning and maintenance	NSF Certified Greenguard Gold - Indoor Air Quality Certified® FSC® Certified
Formica® Compact	Formica® Compact is a solid structural laminate engineered for self-supporting applications without a substrate. It offers exceptional resistance to impact, moisture, humidity, and wear. Frequently specified for toilet partitions, lockers, furniture, and built-in fixtures in commercial and institutional spaces.	Elevator cabs Room dividers Wall panels Lockers and cabinets Restroom partitions Utility compartments	Structural (no substrate required) Can be drilled, routed, tapped , sanded and shaped Two-sided decorative face High strength, impact, water and humidity resistant Ease of cleaning and maintenace	Greenguard Gold - Indoor Air Quality Certified® LBC Red List Approved Class 1/A Fire-rated on FR grades EPD® FSC® Certified ANSI/NEMA LD3-2005 Compliant
180fx® Laminate	180fx® laminate marks a revolution in surfacing with true-to-scale granite, stone and woodgrain patterns that offer visual drama unmatched by any other laminate. Modern, sophisticated high resolution patterns focus on a natural palette - versatile enough to pair with any interior design concept.	Reception Desks Countertops Tables and furniture Doors and walls	Realistic patterns Durable and wear resistant Ease of fabrication Ease of cleaning and maintenance Postformable	NSF Certified Greenguard Gold - Indoor Air Quality Certified® FSC® Certified

For additional information about any materials in the Formica® Portfolio of Surfacing Solutions, please reach out to your Formica® Sales Representative or call 1-800-FORMICA™



For additional information about Formica® Portfolio of Surfacing Solutions and/or to order samples, visit formica.com or call 1-800-FORMICA™ (1-800-367-6422).

Formica®, the Formica® Anvil logo, 180fx®, Everform®, ColorCore®2, and HardStop® are registered trademarks of The Diller Corporation. 1-800-FORMICA™, InDepth Surfacing™, and Formica Envision™ are trademarks of The Diller Corporation.

FENIX®, Arpa®, Homapal®, and TRESPA® TopLab® are property of their respective owners.